



Global 1.0/1.5 series

Front control,Rear control,Pod
Instruction manual

Tianjin FUBER Technology Co.,Ltd

Create ship power equipment supporting products with first-class user experience

Use instructions

Before using the product, please read this manual fully to understand the correct and safe operation method. The use of this product represents that you have fully read and agreed to the terms and safety matters in this manual. The Technology is not responsible for any property damage or personal injury caused by operations not complying with the provisions of this manual.

Use the legend

When reading this manual, please refer to the following figure legends:

(1) 、  Important

(2) 、  instructions

CONTENTS

01	Product features
02	Appearance Ports
03	Installation Instructions
04	Start Operation Instructions
05	Shutdown Operation Instructions
06	Operating Instructions For Raising The Fuselage
07	Handle Installation And Operation Instructions
08	Instructions For Quick Disassembly Of Batteries
09	Control Conversion Instructions
10	Disassembly And Instructions For Sacrificial Anode
11	Fault Protection And Recovery Operation Instructions
12	Storage Instructions
13	Maintenance And Repair Instructions



01 / Product Features



warning:

To avoid product losses caused by improper operation, please read all the operation instructions and safety information in this manual first, and then use FUBER products. For more product information, please log in to: www.sea10000.com for inquiries.

- 1、 The display screen shows real-time operation information.
- 2、 The emergency safety switch ensures safety.
- 3、 The rudder lever type throttle operates smoothly.
- 4、 The battery power alarm reminds you.
- 5、 Deep-sea grade anti-corrosion coating.
- 6、 Built-in GPS positioning.

02 / Appearance Ports

- ① Charging port
- ② Discharge port
- ③ 12V Discharge port
- ④ Display screen
- ⑤ Screen buttons
- ⑥ Magnetic suction safety buckle
- ⑦ Fixed main seat
- ⑧ Accelerograph handle
- ⑨ Tightening handle
- ⑩ propeller
- ⑪ Propeller hub cap
- ⑫ Drivemodule
- ⑬ Motor module

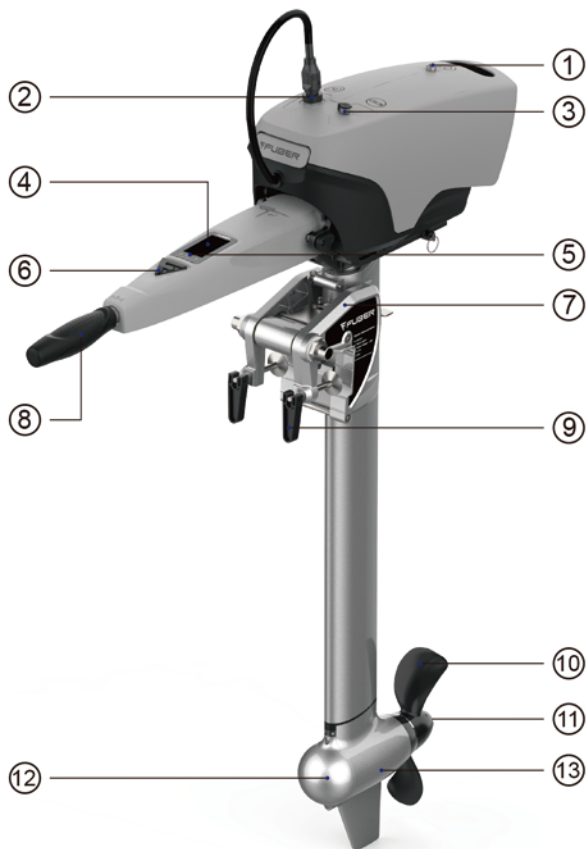

03 / Installation Instructions

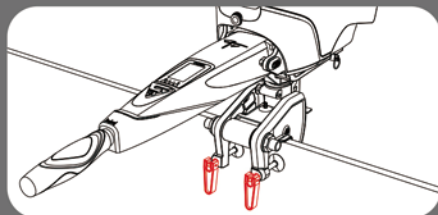

Front control stern control

1 Hang the product on the hanging plate on the stern plate of the ship used to fix the outboard motor and rotate the handle of the locking clamp.

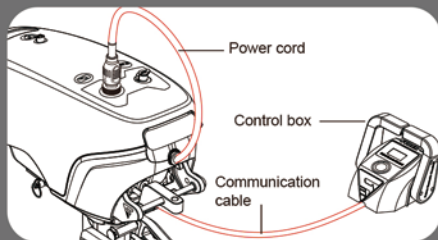

2 Front control version:
For the female end of the waterproof connector of the power cord, plug it into the male end of the power connector at the handle end of the product and rotate to lock it (refer to the picture below). Connect both ends of the communication cable to the product and the control box respectively.

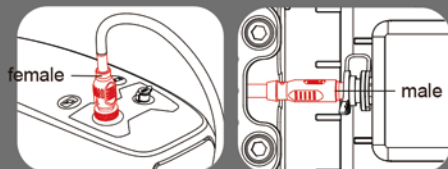

2 Stern control version:
For the female end of the waterproof connector of the power cord, plug it into the male end of the power connector at the handle end of the product and rotate to lock it

Must-read before installation.

(Includes front control/ stern control/ pod.)

-  a. Avoid battery short circuit when connecting.
- b. Once the power cord or communication cable is interrupted, the outboard motor will stop working.



- a. When installing, ensure that the connector is dry to prevent short circuits.
- b. Please clean the connection connector once every three months.
- c. During use, if poor contact is found, it is recommended to check the connection and fastening of each terminal.

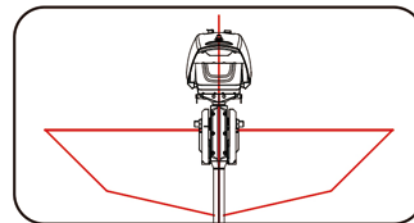

Please be sure to fix this product on the central axis of the ship. If your ship is asymmetrically designed, please consult an authorized dealer of FUBER Technology to adjust the appropriate installation position.



For long-term continuous use, it is recommended to use bolts to connect the equipment from the spare fixing holes to the hull to enhance the locking effect.

03 / Installation Instructions Pod

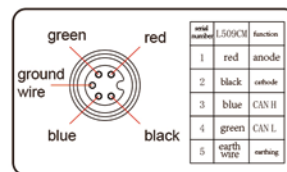

Female end of wiring harness (Figure 1)

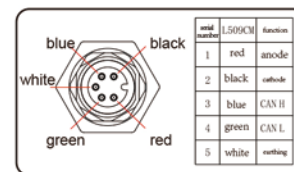

Male end of control box (Figure 2)

Note: The flatness requirement of the ship board is 0.1mm and the roughness is 3.2μm.

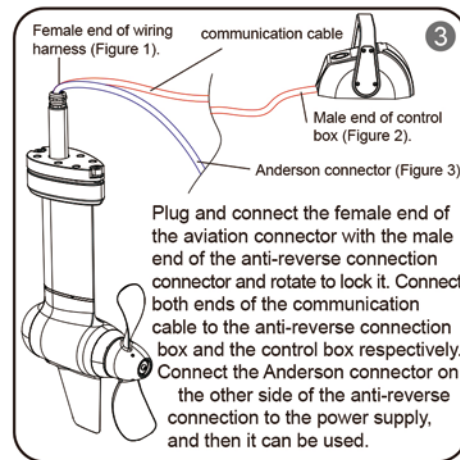
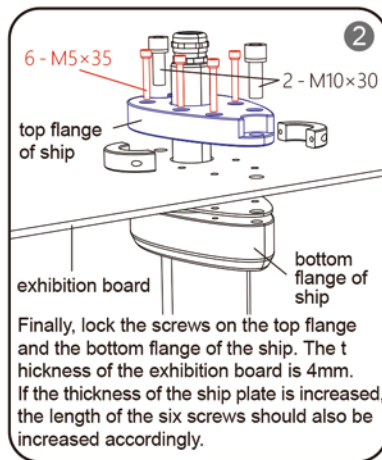
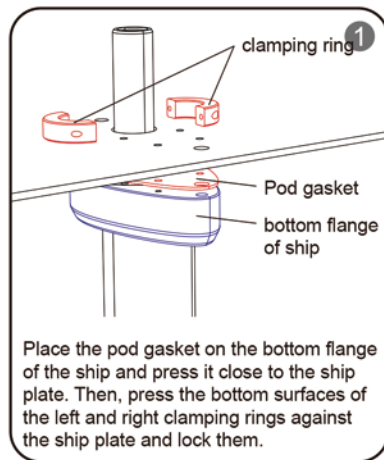

03 / Installation Instructions

Azimuth podded thruster

Note: The flatness requirement of the ship board is 0.1mm and the roughness is 3.2μm.

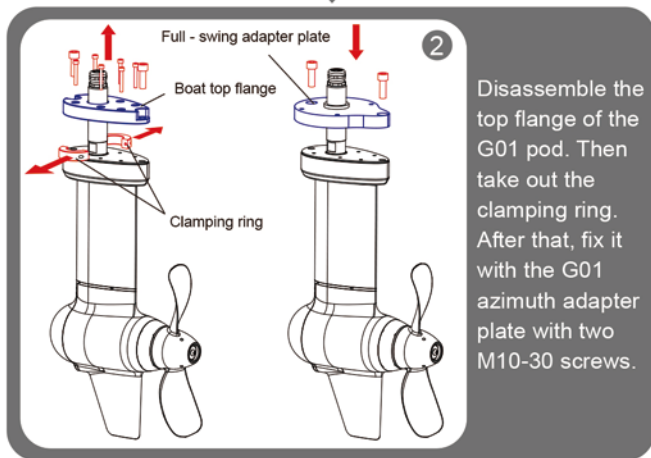
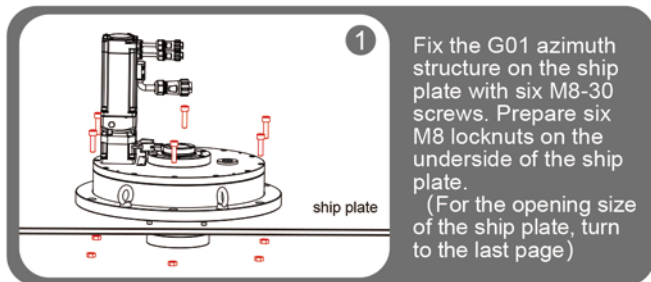

Finally, fix the G01 pod assembly to the main body of the full-rotation pod with four M5-30 screws. Then the installation of the overall full-rotation pod is completed.

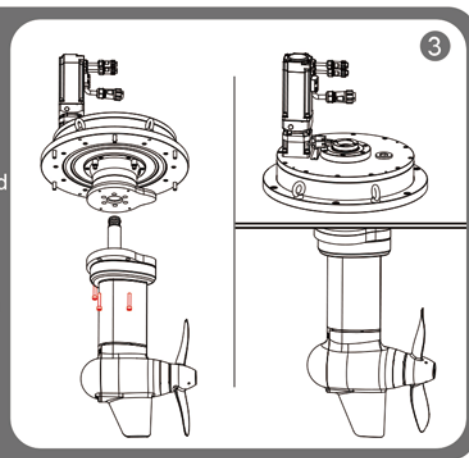

Must-read before operation (including front operation/rear operation)



Please check the following items before startup:

- a. Confirm whether the propeller is locked.
- b. Ensure that the product is completely locked to the stern plate and in the correct position.
- c. Verify whether the safety switch is in the handle placement position.
- d. Check and confirm whether the battery installation slot is fixed (Chapter 08).
- e. Check and confirm whether the handle connecting rod is tightened.
- f. Check whether the throttle handle can rotate smoothly.
- g. Examine whether all connections are in good condition and free from aging.
- h. Inspect whether the power connection part is dry to avoid short circuits.



Please check the following items before startup:

- a. Please confirm whether the propeller is locked.
- b. Please ensure that the product is completely locked to the stern plate and in the correct position.
- c. Please confirm whether the safety switch is in the handle placement position.
- d. Please check and confirm whether the battery installation slot is fixed (Chapter 08).
- e. Please check and confirm whether the handle connecting rod is tightened.
- f. Please check whether the throttle handle can rotate smoothly.
- g. Please check whether all connections are in good condition and free from aging.
- h. Check whether the power connection part is dry to avoid short circuits.

04 / **Start Operation Instructions**

04 / Start Operation Instructions

Rear control

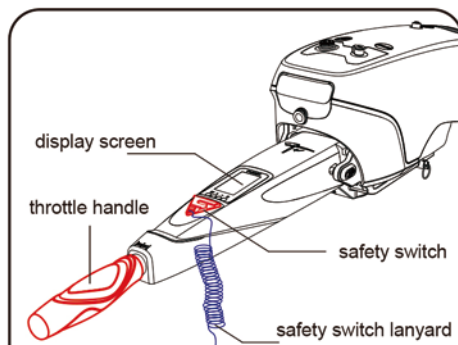

- ① Place the safety switch in the position shown in the figure.
- ② Tie the lanyard of the safety switch to the operator's wrist or on the clothing.
- ③ Turn the throttle handle to power on. At the same time, it can control forward (turn left) or backward (turn right).

display screen

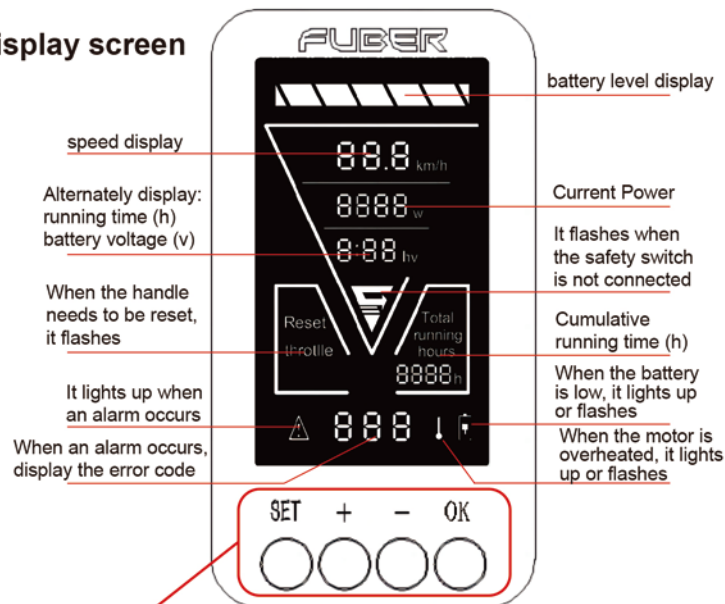

1. OK button: In the shutdown state, press and hold to start up. In the startup state, press and hold to shut down. Short press to immediately refresh the screen display.
2. After holding down the SET button, press the "+" and "-" buttons to increase or decrease the output power.
3. After holding down the "+" button, press the SET button (for more than 10 seconds) to calibrate the handle.
4. When the machine is shut down, after holding down the "-" button, press the SET button (for more than 10 seconds) to clear the alarm.

Fault Code Analysis and Suggested Solutions



serial number	Screen fault display	fault analysis	Suggested Solutions
1	A01:The motor is not connected.	The motor cable is disconnected from the display board.	After confirming that the cable is restored and connected, the fault display will automatically disappear. Otherwise, since it is impossible to determine the problems of the display board circuit and the motor circuit, it needs to be returned to the factory for after-sales service.
2	A02:The battery is not connected.	The battery is disconnected from the display board.	After confirming that the battery is restored and connected, the fault display will automatically disappear. If the display still exists, further confirm whether a battery certified by Feibot has been used. Otherwise, it needs to be returned to the factory for after-sales service.
3	A03:The handle is abnormal.	The rotation of the handle cannot be detected by the controller.	Confirm that the encoder chip is reliably connected to the display board. Otherwise, it needs to be returned to the factory for after-sales service.
4	B01:Motor overheat alarm.	The current operating temperature of the motor exceeds the standard temperature range. Continued operation will cause shutdown due to high temperature protection.	Reduce the throttle and run until the high temperature alarm stops, or shut down and cool for a period of time and restart the machine.
5	B02:The motor shuts down due to high temperature.	The operating temperature of the motor exceeds the required maximum temperature. The product shuts down protectively.	Restart the machine after cooling for a period of time.
6	C01:Abnormal switch status.	Cable malfunction or the switch button fails to reset properly.	After confirming that the button wiring is correct and ensuring that the button can be turned on and off normally, if the alarm still shows, it needs to be returned to the factory for after-sales service.
7	B03:Abnormal operation status 01.	Stalled rotation or overcurrent fault. The propeller is obstructed in operation due to being entangled with grass or fishing nets, etc.	Clean it and restart the machine.
8	B04:Abnormal operation status 02.	Power over - voltage. Non - specified - manufacturer batteries were used, or the battery specifications were used incorrectly and are higher than the product's operating voltage range.	Select the specified battery brand and connect the battery of the specified specification as required.
9	B05:Abnormal operation status 03.	Power under-voltage. The battery is discharged and the voltage is too low. Non-specified-manufacturer batteries were used, or the battery specifications were used incorrectly and are lower than the product's operating voltage range.	Use the battery again after it is fully charged.

04 / Start Operation Instructions

Front control

Product model	00000		Battery Level Indicator
Power-on duration	0.00h	0000h	Cumulative duration
	00km/h		Current speed
Battery Power	00.0kW	000.0V	Cell Voltage

Single-control display screen

Product model	00000		Battery Level Indicator
Power-on duration	0.00h	00km/h	Cumulative duration
	0000h		Current speed
Battery Power	00.0kW	00.0kW	Cell Voltage
	000.0V	000.0V	

Dual-control display screen



- 1 Place the safety switch in the position shown in the figure.
- 2 Tie the lanyard of the safety switch to the operator's wrist or on the clothing.
- 3 Press the "POWER" button to turn on the machine.

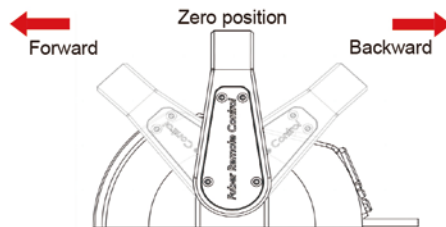

- 4 After the control box is turned on and started, slowly push the throttle to the forward or backward position and increase the throttle power in between.



Before starting the control box, please return the throttle to the zero position.

When directly turning the throttle from the forward position to the backward position, the outboard motor will first stop running briefly and then rotate in the opposite direction.

05 / Shutdown Operation Instructions

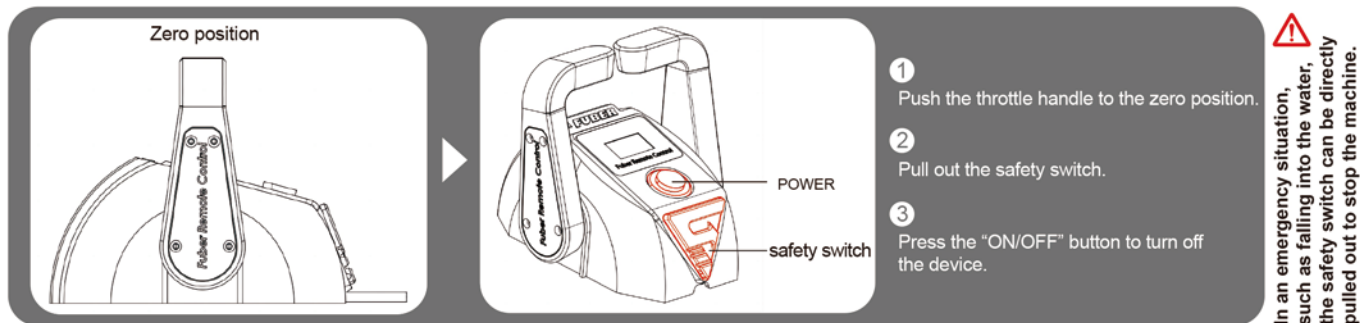
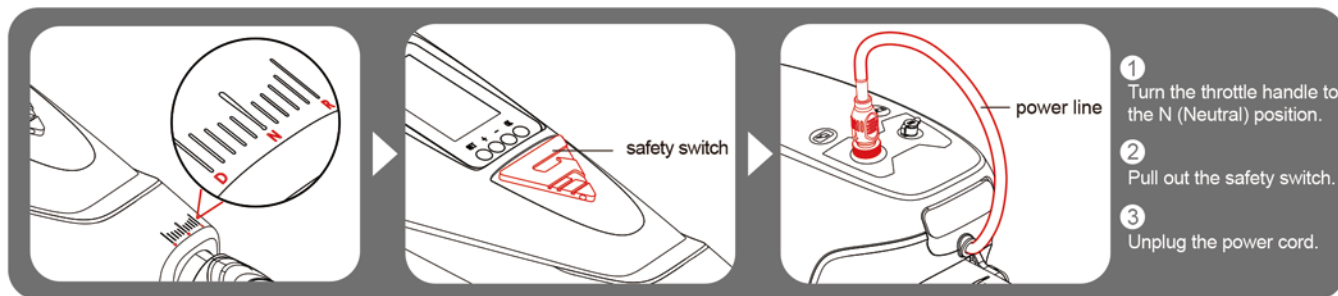

06/Operating Instructions For Raising The Fuselage

- !** a. Only when the outboard motor is stopped can the tilt angle of the outboard motor be adjusted.
b. During the process of adjusting the angle, please operate slowly when tilting up and down to avoid collision damage to people or the machine.
c. When testing the working condition of the tilt angle, please increase the speed slowly and observe the water flow at the stern at any time.
If the water flow is abnormal (such as cavitation of water flow, etc.), please stop the machine immediately and reduce the pitch angle.

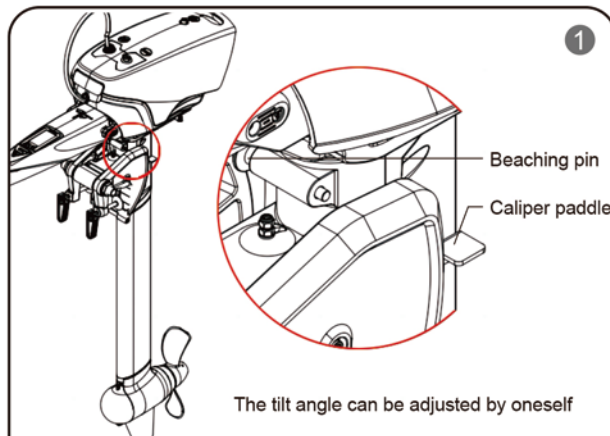

- The product can adjust the tilt angle in the following ways:
a. First, pull out the beaching pin outward and simultaneously flip up the caliper paddle.
b. Then, press down the throttle handle and the fuselage can tilt up.

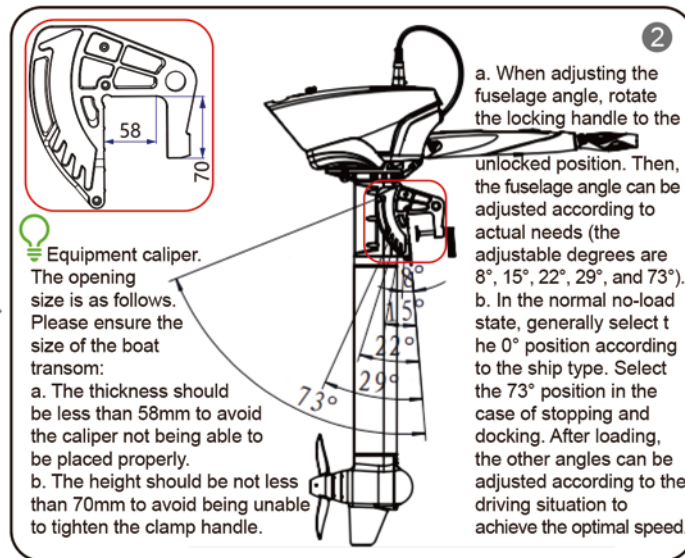

07 / Handle Installation And Operation Instructions

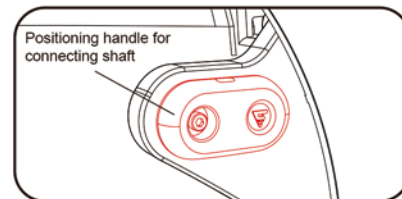
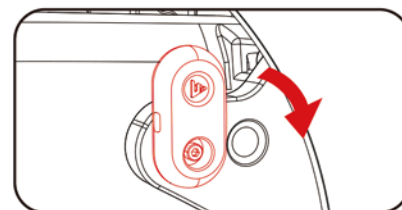
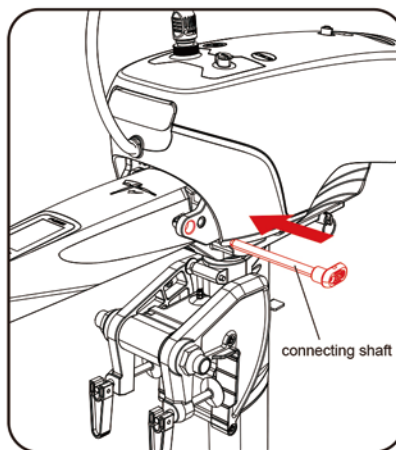
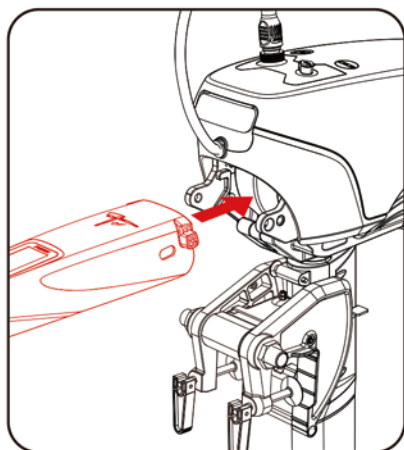

- 1 First, align the notch positions of the handle component and the battery pack component, and then insert the connecting shaft.
- 2 Tighten the connecting shaft. When the inner notch of the connecting shaft positioning handle is clamped to the boss of the battery bracket, it is done.
- 3 Connect the handle control cable.

Install the handle in the above way

08 / Instructions For Quick Disassembly Of Batteries

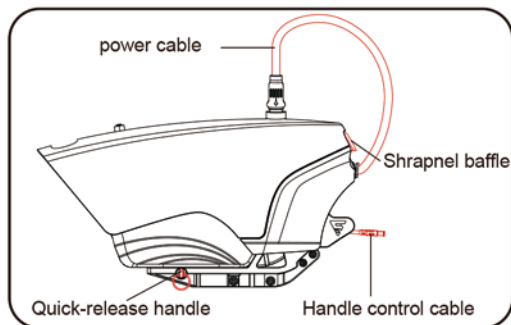

The battery can be disassembled and assembled in the following ways

- ① Disconnect the power cable and the handle control cable.
- ② Pull out the quick-release handle outward and rotate it 90° clockwise or counterclockwise to be stuck with the rib of the battery bracket. Then, flip up the shrapnel baffle. At this time, lift it up forcefully to disassemble the battery part.

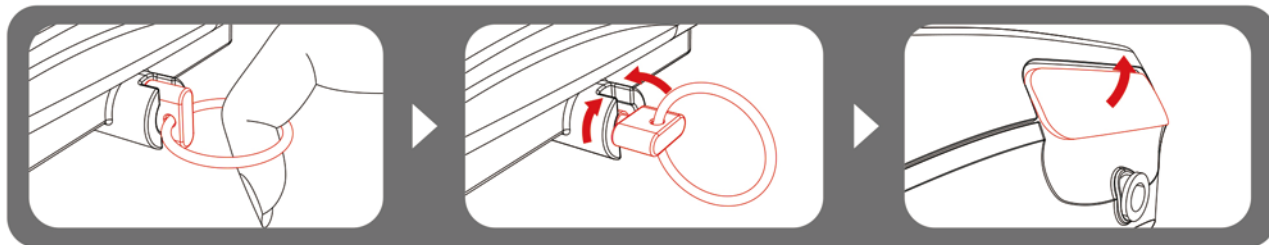

09 / Control Conversion Instructions

The conversion can be operated in the following ways

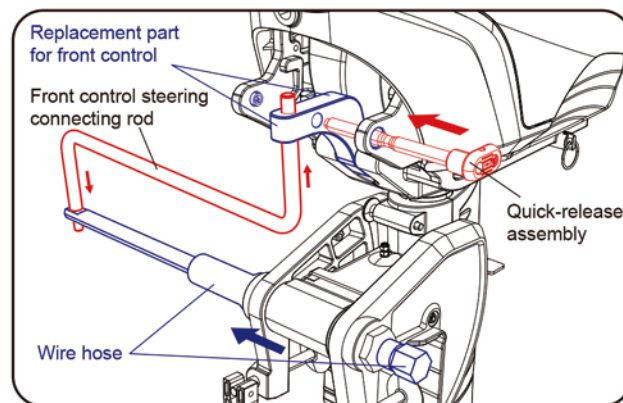
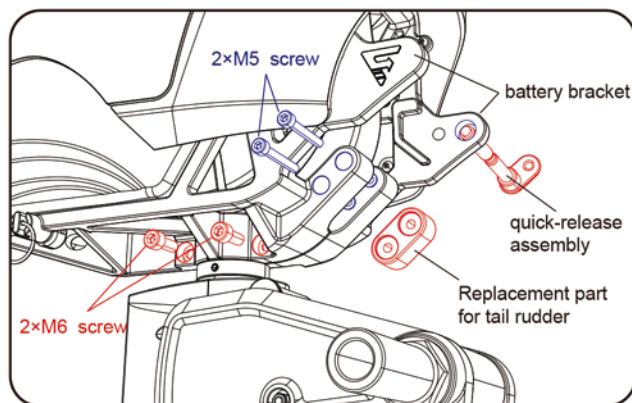

- 1 After removing the handle, loosen the two M6 screws of the left and right battery brackets.
- 2 Unscrew the two M5 screws of the tail rudder replacement part, remove the tail rudder replacement part (Figure 1), and replace it with the front control replacement part (Figure 2).
- 3 Insert the hose into the caliper threaded tube. Then, align the front control steering connecting rod with the hole positions of the front control replacement part and the hose and tighten the locknut.
- 4 Tighten the two M5 screws of the front control replacement part and the two M6 screws of the left and right battery brackets. Finally, screw the quick-release assembly into the thread of the battery bracket to complete the front control transformation.

10 / Disassembly And Instructions For Sacrificial Anode

Instructions:

When the corrosion of the sacrificial anode reaches a certain degree, it should be replaced. The process of replacing the anode is relatively simple and usually involves removing the old anode and installing a new one. However, before proceeding with the replacement, it must be ensured that the new anode is ready and meets the requirements. In addition, checking the corrosion condition of the metal structure is also an important step to ensure that the performance of the anode is not impaired.

Use an M3 hex key to unscrew the screw, and then the sacrificial anode can be removed.

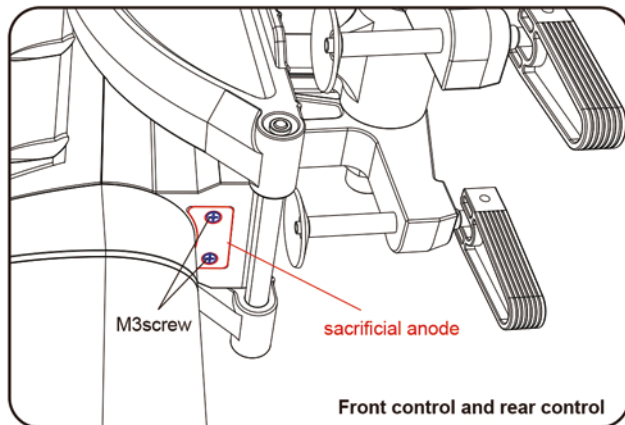

Use an M3 Phillips screwdriver to unscrew the screw, and then the sacrificial anode can be removed.

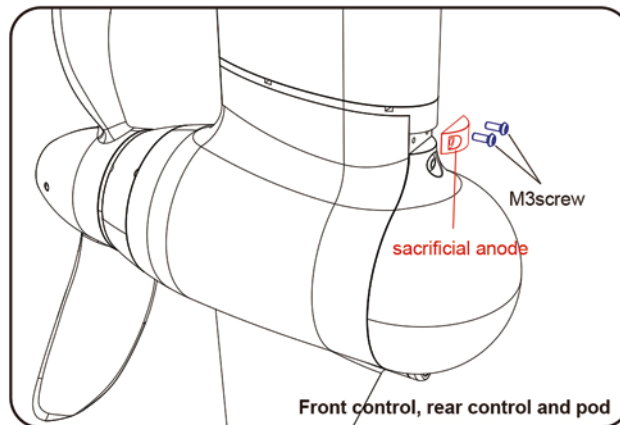

11 / Fault Protection And Recovery Operation Instructions

This product is equipped with a protection function. If the propeller stops rotating due to incorrect operation of the machine, turn the throttle handle to zero position and wait for 2 seconds. Then rotate the throttle again and the machine can be restarted.

Situations that generally cause the propeller to stop rotating are as follows:

- a. The safety switch falls off during operation.
- b. The propeller is wrapped with grass or foreign objects, resulting in a locked - rotor condition.
- c. The throttle handle is not in the zero position when restarting the machine.

The above are common situations for shutdown. After such situations occur, perform the restart operation. If the machine cannot be restarted, please contact the dealer or agent for handling. Do not disassemble the machine by yourself to avoid danger.

12 / Storage Instructions

If the outboard motor needs to be stored for a long time (more than 2 months), it is recommended to contact your agent before storage for an inspection and clean the outboard motor once to prevent corrosion by seawater. Then, use the original factory packaging scheme at the time of shipment to package the outboard motor for long-term storage.



- a. Please be sure to take shock absorption and protection measures before storing and transporting the outboard motor. During the process, please ensure that the outboard motor is placed flat.
- b. Please store the outboard motor in a dry and ventilated place and avoid direct sunlight.

When placing it temporarily, place the outboard motor flat on the ground. Use the pearl cotton or foam board in the packaging to pad under the machine to avoid damaging the outboard motor.

13 / Maintenance And Repair Instructions

Notes:

Do not start the outboard motor on the shore or in shallow water, and adjust the outboard motor to the highest 73° gear to avoid touching the bottom. Wait until the water depth is sufficient to use the outboard motor, and then adjust the outboard motor to the appropriate gear to start.

After using this product in seawater, please promptly clean the immersed parts with fresh water to reduce corrosion.



- a. Please be sure to carry out maintenance under the operation guidance of professionals or agents.
- b. Please be sure to perform maintenance or repair when the outboard motor power is off.
- c. If the parts of the product are damaged or need to be replaced, please be sure to use the original accessories of Fibos Technology.
- d. At any time when checking and disassembling the propeller, please ensure that the power is disconnected to prevent accidental startup of the machine.

Propeller inspection steps:

- a. Check the wear and corrosion of the propeller blades.
- b. Remove the entangled debris on the propeller (such as fishing nets, fishing lines, aquatic plants, etc.).



Product identification nameplate:
The product nameplate is the proof for product warranty or other after-sales services. It is located as shown in the figure below. Please find the face sticker on the product and record the product serial number. Do not tear off the face sticker; otherwise, the product warranty will be invalid.

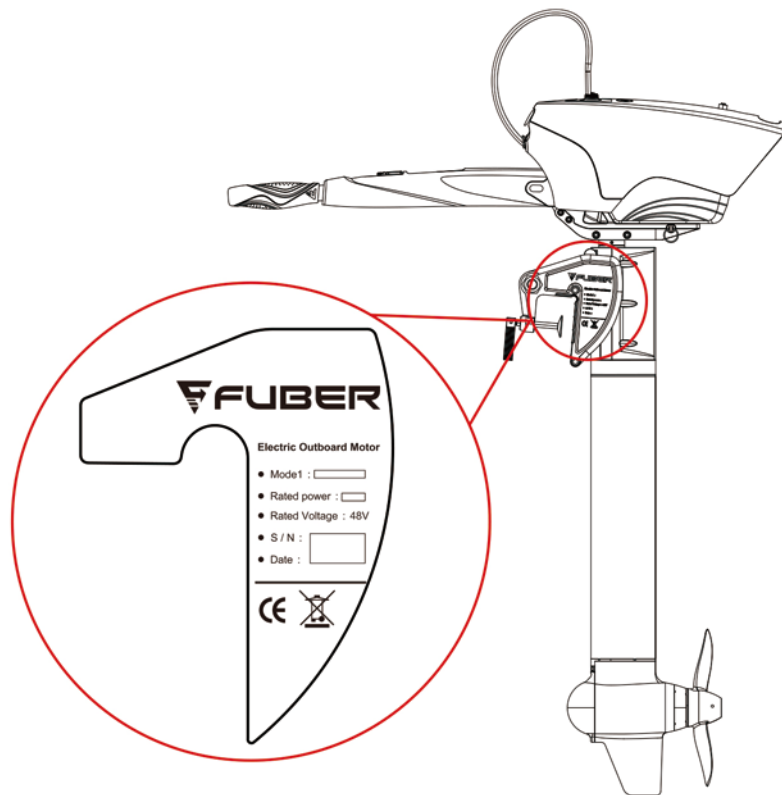

Pod - Drilling holes in the ship board.

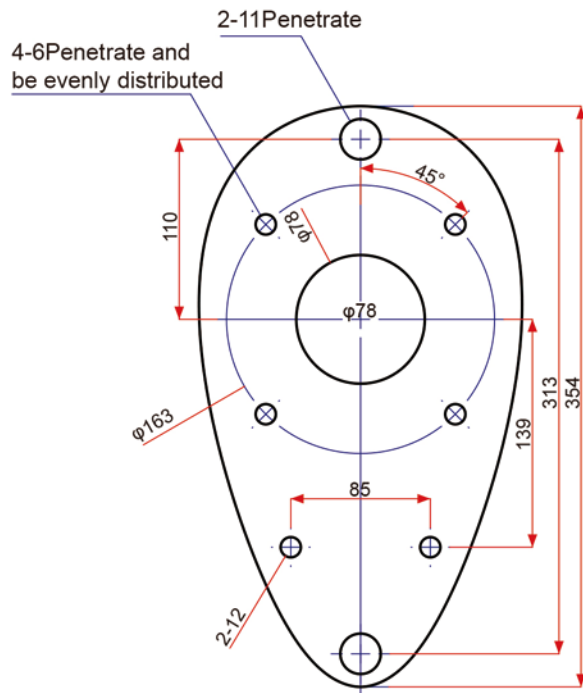

Full-swing pod - Drilling holes in the ship board.

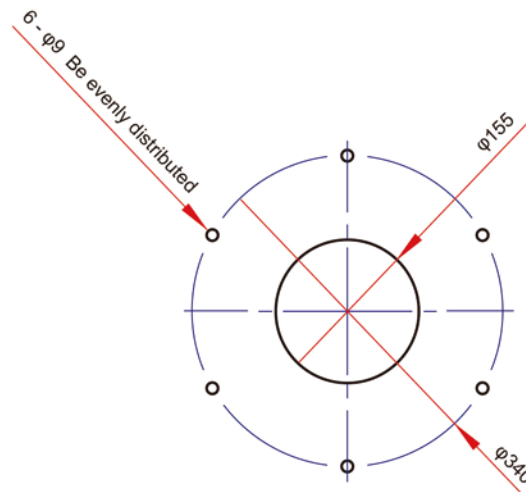



contact number: 400-090-3969

official website: <http://www.sea10000.com/>

company address: GuChuan High-tech Industrial Park#29,Beichen District,Tianjin